



Quote # QUO0000003075

Prepared For:

VCI Emergency Vehicle Specialists
 43 Jefferson Avenue
 Berlin, NJ 08009
 Phone: 800-394-2162
 Fax: 856-768-6933
 Milt Grimes

Presented By:

VCI Emergency Vehicle Specialists
 43 Jefferson Avenue
 Berlin, NJ 08009
 Phone: 800-394-2162
 Fax: 856-768-6933
 Milt Grimes

Option	QTY	Description
Chassis		
CO00029262	1	This vehicle will comply with CN10 and CN11
SR00029274	1	PREVIOUS PRODUCTION # 18394 NOT AN EXACT DUPLICATE
1000-0002	1	AMBULANCE SPECIFICATIONS
1000-0630	1	CHASSIS, 2019 FORD E-450, 158 The chassis required to complete the ambulance conversion shall be supplied by Horton.
1000-0072	1	CHASSIS ORDERED WITH STEEL WHEELS The specified chassis is to be ordered to include OEM steel wheels.
1000-0338	1	WALK THROUGH CAB/MODULE, E SERIES Provide a walkthrough opening between the cab and the patient compartment. A walkthrough door, if required, will be specified separately.
1000-0342	1	STAINLESS STEEL FULL COVERS, E SERIES Install stainless steel wheel covers on all outside wheel.
1000-0344	1	BRAIDED VALVE EXTENSIONS, E SERIES Install stainless steel braided filler extensions on the rear tires. Fasten to the center wheel hub with stainless steel brackets.
1000-0083	1	STANDARD CAB HEIGHT The specified chassis will have the standard cab height.
1000-0345	1	MUD FLAPS, REAR, SMALL W/LOGO Install individual rear mud flaps behind each set of rear wheels. Mud flaps to include Horton logo.

Option	QTY	Description
1000-0087	1	REAR DOCK BUMPERS Install two (2) black rubber standard sized dock bumpers. Locate one on either side of the rear step on the end caps.
1000-0090	1	REINFORCE REAR BUMPER END CAPS Reinforce end caps of rear bumper for greater impact resistance.
1000-0103	1	RUNNING BOARDS: STAR PUNCHED, E SERIES Install heavy duty aluminum diamond plate running boards and splash shields. Running boards are to be star punched for enhanced drain and foot grip.
1000-0225	1	REAR STEP/ BUMPER ASSEMBLY, E SERIES Install a diamondplate rear step/bumper assembly with flip-up center section.
BODY		
SR00029275	1	Reinforce floor for dealer installed center mount cot retention system.
2000-0101	1	AMBULANCE BODY Conversion model is to be a 553-III using a Ford E450 chassis.
2000-0013	1	HEADROOM, 72" The headroom is to be 72".
2000-0625	1	ALUM. DIAMONDPLATE AT SIDE STEPWELL Fabricate the stepping surface inside the side access door using polished aluminum diamond treadplate.
2000-0243	1	DOUBLE STEP CURBSIDE ENTRY, 3" DROP SKIRT Fabricate curbside of body with 3" drop skirt. To include two step side entry.
2000-0244	1	STREETSIDE 3" DROP SKIRT Fabricate streetside of body with 3" drop skirt.
2000-0250	1	SOUND PROOFING/ACOUSTIC ENHANCEMENT PACKAGE Install standard sound control package.
2000-1050	1	ROOF POCKET, AUXILIARY CONDENSER Install a roof pocket for a CoolTech I unit.
2000-0506	1	ELECTRONIC PRIVACY WINDOW For Rear Entry Doors Two (2) fixed electronic privacy windows shall be installed in the rear entry doors.
2000-0500	1	ELECTRONIC PRIVACY For Side Entry Door A fixed electronic privacy window shall be installed in the side entry door.
2000-0265	2	EMERGENCY RELEASE, REAR DOORS Install standard emergency release knobs on top and bottom of the rear module entrance doors.

Option	QTY	Description
2000-0704	1	EMERGENCY RELEASE, SIDE ACCESS DOOR Install emergency release knobs on top and bottom of the side module entrance door.
2000-0266	1	VI-TECH MOUNTING, E SERIES Install standard Vi-Tech body mounts.
2000-0270	1	MIRROR STAINLESS STEEL SPLASH SHIELDS Install #8 mirror stainless splash shields on the lower front face of the body just behind the cab access doors. These splash shields are to be the same height as the diamond plate front corner guards.
2000-0596	1	PRE PUNCH SPLASH SHIELDS The specified front splash shields are to be pre-punched to accept the specified running board lights.
2000-0688	1	FENDERS, STAINLESS, STD, CS 3" DROP SKIRT Install a stainless steel fender, for use in conjunction with a 3" drop skirt, at the curbside rear wheelwell location.
2000-0689	1	FENDERS, STAINLESS, STD, SS 3" DROP SKIRT Install a stainless steel fender, for use in conjunction with a 3" drop skirt, at the streetside rear wheelwell location.
2000-0220	1	POLISHED STAINLESS RUB RAILS, LIGHTED Install polished stainless steel lower body rub rails. Rails are to include cutouts for strip lighting.
2000-0652	1	STANDARD CORNER GUARDS Install standard height polished diamondplate corner guards.
2000-0281	1	REAR DOOR HOLD OPENS, GRABBER Install chrome Cast Products "Grabber" style rear door hold opens. (NOTE: HOLDOPENS MUST BE RELOCATED IF TELESCOPIC LIGHTS ARE ORDERED)
2000-0584	1	REAR RISER ADP The rear riser is to be fabricated out of polished aluminum diamondplate.
2000-0684	1	LICENSE PLATE BRACKET, CENTER OF RISER Install a recessed rear license plate bracket centered in the rear riser. Include an LED license plate light.
2000-0282	1	FUEL FILL PLATE Install a stainless steel plate on the body face below the fuel fill housing.
2000-0598	20	DOOR REFLECTORS All patient compartment entry doors to include standard red reflectors.
SR00029271	1	The three patient entry door inner door panels will have red and white printed scotchlite arrow style door panels. Previous vehicle reference 18394
COMPARTMENTATION		
2900-1496	1	STREETSIDE FORWARD COMPARTMENTS The height of the streetside front compartment is to be the reduced. An electrical compartment is to be installed above the primary compartment. See drawings for

Option	QTY	Description
		compartment dimensions. Both compartments are to include standard LED strip lighting and single hinged doors.
2000-0400	1	SS FORWARD COMPT. DIAMONDPLATE The streetside forward compartment is to be fabricated from diamondplate.
2900-0095	1	SILL PLATES, STREETSIDE FRONT Install a stainless sill plate on the streetside forward compartment.
2900-1498	1	STREETSIDE INTERMEDIATE COMPARTMENT The height of the streetside intermediate compartment is to be the full available height to the bottom of the interior countertop. See drawings for compartment dimensions. Compartment is to include standard LED strip lighting and double hinged doors.
2000-0402	1	SS INTRMDT COMPT. DIAMONDPLATE The streetside intermediate compartment is to be fabricated from diamondplate.
2900-0144	1	ADJUSTABLE SHELF STREETSIDE INTERMEDIATE - CENTERED Install diamond plate adjustable shelving in the streetside intermediate compartment. Locate as noted.
2900-4005	1	SILL PLATES, STREETSIDE INTERMEDIATE Install a stainless sill plate on the streetside intermediate compartment.
2900-1501	1	STREETSIDE WHEELWELL COMPARTMENT Install a compartment above the streetside wheel house. The door for this compartment is to be fixed to the face of a slide-out tray housed within the compartment. Install Accuride slides on tray. See drawings for compartment dimensions. This compartment does not include lighting.
2000-0252	1	WHEELWELL COMPT. DIAMONDPLATE The specified wheelwell compartment is to be fabricated from polished aluminum diamondplate.
2900-1504	1	STREETSIDE REAR COMPARTMENT The height of the streetside rear compartment is to be 1/2 of the available height of the body. See drawings for compartment dimensions. Compartment is to include standard LED strip lighting and double hinged doors.
2000-0404	1	SS REAR COMPT. DIAMONDPLATE The streetside rear compartment is to be fabricated from diamondplate.
2900-0145	1	ADJUSTABLE SHELF STREETSIDE REAR - CENTER IN OPENING Install diamond plate adjustable shelving in the streetside rear compartment. Locate as noted.

Option	QTY	Description
2900-4007	1	SILL PLATES, STREETSIDE REAR Install a stainless sill plate on the streetside rear compartment.
2900-1507	1	CURBSIDE REAR COMPARTMENT The height of the curbside rear compartment is to be full height of the available height of the body. See drawings for compartment dimensions. Compartment is to include standard LED strip lighting and a single hinged door.
2000-0409	1	CS REAR COMPT. FLAT ALUMINUM The curbside rear compartment is to be fabricated from flat aluminum.
2900-0148	3	ADJUSTABLE SHELF CURBSIDE REAR - SPACED EVENLY ABOVE STAIR CHAIR STORAGE WITH THE BOTTOM SHELF AT 43" ABOVE THE COMPARTMENT FLOOR Install diamond plate adjustable shelving in the curbside rear compartment. Locate as noted.
2900-4070	1	FIXED VERTICAL DIVIDER, CURBSIDE REAR - 15" from right wall. Install a 16" deep fixed vertical divider in the curbside rear compartment. Locate as noted above.
2900-0266	1	ROK BACKBOARD STRAP CURBSIDE REAR - Between left wall and divider. Install a Rok buckle style backboard strap in the designated compartment.
2000-0611	1	SWEEP OUT COMPARTMENT FLOOR CS REAR COMPT Curbside rear compartment floor is to be sweep-out style.
2900-4001	1	STAIR CHAIR POCKET, CURBSIDE REAR A stair chair pocket is to be recessed into the curbside rear compartment inner door panel. The pocket shall be installed as close to the bottom and hinged side of door as possible. See drawings for dimensions.
2900-2956	1	STAIR CHAIR MODEL, STRYKER #6252 A Stryker #6252 stair chair will be stored as noted. This is for sizing/placement purposes only. Horton is not to supply this equipment.
SR00029278	1	Horton to fabricate and install hat section on forward facing wall of CS rear compartment to build out wall for stairchair installation.
2900-4008	1	SILL PLATES, CURBSIDE REAR Install a stainless sill plate on the curbside rear compartment.
2900-1511	1	CURBSIDE FORWARD COMPARTMENT The height of the curbside front compartment door is to be the full available height of the body. See drawings for door dimensions. Compartment is to include standard LED strip lighting and a single hinged door.

Option	QTY	Description
2900-4010	1	SILL PLATES, CURBSIDE FRONT Install a stainless sill plate on the curbside forward compartment.
3000-0127	1	PULL OUT TRAY FOR 2-BATTERY SYSTEM Install a custom battery tray for (2) batteries in the battery compartment.
2900-1200	1	MATEFLEX, BLACK Black Mateflex is to be installed on the floor and shelving of all exterior compartments. To include tapered edge trim pieces where applicable.
2900-0113	1	RUBBER WALLS IN BB COMPT, GRAY The interior of the backboard compartment is to be covered with gray rubber matting to protect equipment stored in this area.
2900-0114	1	GRIP LOCK, FACE OF EXTERIOR SHELVES AND DIVIDERS Install grip lock trim on the edges of the compartment shelves and any vertical dividers.
PAINT AND GRAPHICS		
5000-0003	1	CHASSIS PAINT: WHITE Chassis color to be standard white.
5000-0007	1	MODULE PAINT, WHITE Paint module standard white to match chassis.
5000-0300	1	DIAMONDGRADE CHEVRON, REAR PANELS - Red, Fluorescent Yellow/Green Install Diamondgrade chevron striping on the rear of the body inboard of the corner posts and below the upper dripail. Exclude rear entry doors.
INTERIOR FEATURES		
2000-0288	1	ACRYLIC COLOR: LIGHT TINT All acrylic doors to be light tint.
2000-0825	2	COUNTERTOP, MERAPI - Standard Locations Install solid surface countertop(s) in lieu of stainless steel. Material is to include radiused and tapered corners and is to have a polished finish. Color is to be Merapi. Locate as noted above.
2000-0592	1	PAINTED STANDARD INHALATION AREA WALLS The main wall action area walls are to be painted to match the remainder of the interior cabinets.
2000-0303	1	INHALATION PANEL, LAMINATE COVERED The inhalation panel is to be fabricated from composite material and covered with laminate to match to color selected.
2000-0304	1	INHALATION PANEL CLOSEOUT Install a D/A finished aluminum close-out on the bottom of the inhalation panel. Panel includes a hinge-down door to access the O2 bypass valves.
2000-0627	1	LONSEAL LONPLATE BLACK

Option	QTY	Description
		The patient area floor is to be covered in Lonplate Black.
2000-0324	1	STAINLESS STEEL RISERS Install stainless steel on the interior risers. If a cabinet riser accent stripe is ordered the stainless steel will stop at the bottom edge of the stripe.
2000-0325	1	STAINLESS STEEL LOWER DOOR PANELS Finish lower section of inside patient compartment doors with stainless steel.
2000-0441	1	WILSONART FASHION GRAY #D381, WALLS The interior walls are to be made of reinforced structural composite board covered with Wilsonart Fashion Gray #D381 laminate. This does not apply to areas surrounding the inhalation/CPR seat area.
2000-0667	1	FASHION GREY CABINET COLOR All interior cabinetry is to be painted Fashion Grey.
2000-0710	1	CABINET PAINT TO BE TEXTURED The specified cabinet paint is to have a textured finish.
2000-0942	1	BLACK BOLTAFLX VINYL COLOR All seat cushions, backrests and vinyl closeouts are to be covered in Black Boltaflex colored material.
2000-0908	1	USSC CHILD, BLACK 4-POINT, BLACK SIERRA Install a Black Sierra USSC high back bucket seat with integral child safety seat and black 4pt seatbelt with safety vest. The seat to be adjustable front to rear and is to be mounted at the head of the cot.
2000-0680	1	4 POINT SEAT BELT CENTER OF BENCH, BLACK Install black 4-pt seatbelt with safety vest at the center position of the squad bench.
2000-0681	1	4 POINT SEAT BELT FOOT OF BENCH, BLACK Install black 4-pt seatbelt with safety vest at the foot position of the squad bench.
2000-0682	1	4 POINT SEAT BELT HEAD OF BENCH, BLACK Install black 4-pt seatbelt with safety vest at the head position of the squad bench.
2000-0683	1	4 POINT SEAT BELT, CPR SEAT, BLACK Install black 4-pt seatbelt with safety vest at CPR seat location.
2000-0605	1	ALUMINUM INTERIOR CABINETS All interior cabinets are to be fabricated from aluminum.
3000-1119	1	TUBULAR AIRBAG, ATTENDANT'S SEAT Install a tubular airbag at the attendant's seat. Unit uses an angled upper inhalation cabinet and includes a cabinet beneath the main countertop.
3000-1125	1	HEAD CURTAIN AIRBAG, ATTENDANT'S SEAT Install a head curtain air bag for the attendant's seat for use with a standard linen cabinet.
3000-1123	1	ROLL SENSOR

Option	QTY	Description
		Install the roll sensor in the standard location. Unit includes streetside airbags only.
3000-1127	1	TUBULAR AIRBAG, CPR SEAT LOCATION. Install a tubular airbag forward of the CPR seat.
2000-0575	1	CABINET TRIM RADIUS Install smooth radiused trim molding on all applicable interior cabinets.
2900-0210	1	IV HANGER, CP WITH RUBBER ARM COT CHEST Install a Cast Products recessed IV hanger with rubber arm over the cot chest area.
2900-0208	1	IV HANGER, CP WITH RUBBER ARM BENCH WAIST Install a Cast Products recessed IV hanger with rubber arm over the bench waist area.
2000-0416	1	GRAB RAIL: (2) 2FT ANTI MIC. ANTI SLIP, OVER COT Install (2) 2 foot anti-slip main grab rail with anti-microbial coating. Locate offset toward the main wall over the cot position in the patient area ceiling.
2000-0650	1	GRAB RAIL: 6FT ANTI-MIC, ANTI SLIP, OVER BENCH Install 6 foot anti-slip main grab rail with anti-microbial coating. Locate offset toward the bench wall in the patient area ceiling.
2000-0412	1	VERTICAL RAIL, 2' ANTI-MIC ANTI-SLIP, BOLSTER Install a 2 foot anti-slip grab rail with anti-microbial coating. Locate on the bench bolster at the side access door angled upward toward the forward end.
2000-0413	1	PATIENT DOOR GRAB RAILS: ANTI-MICROBIAL/ANTI-SLIP Install standard 'V' shaped grab rails with anti-microbial coating. Handles are to be anti-slip style. Locate on the interior door panels of all three patient entry doors.
2000-0423	1	CEILING MATERIAL, PLATINUM WHITE COMPOSITE The standard module ceiling material shall be platinum white aluminum composite.
2000-0578	1	FIRE EXTINGUISHERS: 5LB ABC SHIP LOOSE Supply and ship loose a five lb ABC fire extinguisher.
2000-0579	1	FIRE EXTINGUISHERS: 5LB ABC SHIP LOOSE Supply and ship loose a second five lb ABC fire extinguisher.
STREETSIDE CABINETRY		
2000-0337	1	LINEN CABINET Install a standard storage cabinet behind the attendant seat.
2900-1076	1	FIXED SHELF, UPPER LINEN CLOSET Fab and install a fixed aluminum shelf in the upper section of the linen cabinet. Shelf is to be painted to match the cabinet color.
2900-1079	1	ADJUSTABLE SHELF MIDDLE 1 LINEN CLOSET

Option	QTY	Description
		Fab and install an adjustable aluminum shelf in the middle section of the linen cabinet. Shelf is to be painted to match the cabinet color.
2900-1083	1	ADJUSTABLE SHELF LOWER LINEN CLOSET Fab and install an adjustable aluminum shelf in the lower section of the linen cabinet. Shelf is to be painted to match the cabinet color.
2900-2029	2	SOLID LAMINATE-COVERED LINEN CLOSET DOOR Install hinged solid doors on the linen cabinet. Cover in laminate to match the interior.
2900-1070	1	PIANO HINGE FOR LINEN CLOSET TOP DOOR The upper linen cabinet door(s) is/are to use piano style hinge.
2900-1074	1	PIANO HINGE FOR LINEN CLOSET LOWER DOOR The lower linen cabinet door(s) is/are to use piano style hinge.
2900-1056	1	SOUTHCO HD LOCKING LATCH FOR LINEN CLOSET DOOR TOP Install a stainless flush mount HD locking Southco pull latch on the upper linen cabinet door.
2900-1065	1	SOUTHCO LATCH FOR LINEN CLOSET DOOR LOWER Install a stainless flush mount Southco pull latch on the lower linen cabinet door.
2000-0343	1	STREETSIDE WALL WITH CPR SEAT Street side cabinet wall to include a CPR seat.
2000-0310	1	CPR SEAT, 28" WIDTH Streetside CPR seat width to be 28".
2900-4087	1	ANGLED UPPER CABINET, FORWARD OF CPR SEAT The upper cabinet forward of the CPR seat is to be angled.
2900-4086	1	ANGLED UPPER CABINET, AFT OF CPR SEAT - * The upper cabinet to the rear of the CPR seat is to be angled.
2000-2050	1	CUSTOM CABINET, Cabinet 1 - Dimensions: 36.5"W X 18.75"H X 16"D - Location: UPPER REAR MAIN Main wall cabinet #1 dimensions are to be as noted above. Note that dimensions are I.D.
2000-0396	1	ACRYLIC SLIDING, Cabinet 1 Cabinet specified above is to have sliding acrylic doors.
2900-0117	1	LIFT UP CABINET FRAMES INTERIOR Cabinet 1 Install a flip-up restocking cabinet frame on cabinet noted above. Includes gas shocks and latches.
2900-0061	1	INTERIOR SHELVING Cabinet 1 Install painted adjustable shelving in cabinet #1.

Option	QTY	Description
2000-2051	1	CUSTOM CABINET, Cabinet 2 - Dimensions: 36.5"W X 16.75"H X 16"D - Location: LOWER REAR MAIN Main wall cabinet #2 dimensions are to be as noted above. Note that dimensions are I.D.
2000-0521	1	ACRYLIC SLIDING, Cabinet 2 Cabinet specified above is to have sliding 3/8" acrylic doors.
2900-0274	1	LIFT UP CABINET FRAMES INTERIOR Cabinet 2 Install a flip-up restocking cabinet frame on cabinet noted above. Includes gas shocks and latches.
2900-0172	1	INTERIOR SHELVING, Cabinet 2 Install painted adjustable shelving in cabinet #2.
2000-2052	1	CUSTOM CABINET, Cabinet 3 - Dimensions: 18.75"W X 12.75"H X 16"D - Location: LOWER TELEMETRY AREA CABINET Main wall cabinet #3 dimensions are to be as noted above. Note that dimensions are I.D.
2900-2182	1	ACRYLIC HINGED DOOR, Cabinet 3 Cabinet specified above is to have a 3/8" acrylic bottom hinged flip-down door.
2900-0282	1	LATCH, HINGED DOOR: SOUTHCO SS Cabinet 3 Install stainless flush mount Southco pull latches on the selected hinged doors on the cabinet designated above.
2900-0338	1	SELF CLOSING STYLE HINGE Cabinet 3 Cabinet #3 door(s) is/are to use self-closing style hinges.
2900-4103	1	LIFT UP CABINET FRAMES, UPPER INHALATION CABINET Install a flip-up restocking cabinet frame on cabinet noted above. Includes gas shocks and latches.
2000-2058	1	UPPER INHALATION CABINET - 34.75"W X 12.75"H X 16"D Upper inhalation cabinet dimensions are to be as noted above. Note that dimensions are I.D.
2900-1102	1	ACRYLIC SLIDING DOORS, UPPER INHALATION CAB. Cabinet specified above is to have sliding 3/8" acrylic doors.
2900-1094	1	INTERIOR SHELVING, UPPER INHALATION CABINET Install painted adjustable shelving in upper inhalation cabinet.
CURBSIDE CABINETRY		
2000-0359	1	SQUAD BENCH WITH NO CUPS OR WELLS

Option	QTY	Description
		Provide storage under the squad bench lid/cushion(s). The area shall run where possible under the bench. The storage pan is to be fabricated from aluminum and painted to match the interior.
2000-0368	1	HOPS RESTRAINT, BOLSTER, DUAL BOTTLE STORAGE Install a HOPS bolster with vertical pocket for O2 bottle storage in the stepwell area at the head end of the bench. Bottle brackets chosen separately.
2000-0744	1	DOUBLE CUSHION SQUAD BENCH The squad bench cushion is to be two piece.
2000-0380	1	BENCH HOLD OPENS: GAS Install gas spring hold opens on squad bench lid.
2000-0381	1	BENCH HOLD-DOWN: PADDLE LATCHES (PAIR) Install recessed paddle latches into the squad bench riser to retain the squad bench lids in the closed position. The latches shall be both passive and positive.
2000-0382	1	BENCH CUSHION EDGE TRIM: Trim bench cushion edge with protective aluminum trim, to protect horizontal edge of squad bench cushion from tears.
2000-0383	1	BENCH BACK CUSHION: FULL SIZE Install full size bench backrest cushion.
2000-0515	1	S/W DRAWER, REARWARD BENCH Install a pull-out cabinet drawer, mounted on Grant slides, on the curbside of the vehicle, under the foot of the squad bench on the aisle side. This drawer will house both sharps and waste containers supplied by Horton. Paint to match interior.
2900-0068	2	BENCH CABINET W/HINGED DOORS & GLOVE STORAGE Fabricate and install a bench ceiling cabinet above the squad bench with lift up Plexiglas doors. The forward section is to be dedicated to glove storage. This section to include space for three (3) glove boxes with oval access holes. The door over this area is to be hinged.
2900-1130	2	SOUTHCO LATCH OVERHEAD BENCH CABINET Install stainless flush mount Southco pull latches on the bench ceiling cabinet.
SR00029273	1	(3) COMPRESSION STYLE HINGES, OVERHEAD BENCH CABINET Overhead bench cabinet door(s) is/are to use compression style hinges.
2900-0136	1	PASS-THROUGH ACCESS, CURBSIDE REAR Provide I/O access into the curbside rear compartment per drawings.
2900-0400	1	CS REAR I/O ACCESS DOOR, HINGED ACRYLIC The compartment pass-through specified above is to have a 3/8" acrylic vertically hinged door.
2900-0404	1	CS REAR I/O DOOR HINGE, SELF CLOSING STYLE The curbside rear I/O door is to use self-closing style hinges.
SR00029264	1	PASS THROUGH NOTE: Inside/outside access to the curbside rear compartment shall be provided..

Option	QTY	Description
		Width is to be determined by the location of any exterior divider and the height shall start 43" from the exterior compartment floor to interior closeout unless noted otherwise below.
2900-0405	1	CS REAR I/O DOOR LATCH, SOUTHCO SS
FRONT WALL CABINETRY		
2900-0073	1	FRONT WALL CABINET: FLAT ALUM PAINTED The front wall cabinet shall be arranged per drawing. Additional configuration information may follow. Cabinet interior is to be painted to match the interior cabinet color.
2900-1005	1	ACRYLIC HINGED DOORS, Upper front wall Cabinet specified above is to have two 3/8" acrylic vertically hinged doors.
2900-1022	4	SOUTHCO FLUSH SS PULL LATCH TOP FRONT WALL DOOR Install stainless flush mount Southco pull latches on the selected hinged doors on the upper front wall cabinet.
2900-1017	6	SELF CLOSING HINGES TOP FRONT WALL CABINET The upper front wall cabinet door(s) is/are to use self-closing style hinges.
2900-1038	1	ADJUSTABLE SHELF, UPPER FRONT WALL TOP CABINET Fab and install an adjustable aluminum shelf in the upper section of the front wall cabinet as noted. Shelf is to be painted to match the cabinet color.
2900-1039	1	FIXED SHELF FRONT WALL MIDDLE CABINET Fab and install a fixed aluminum shelf in the center section of the front wall cabinet as noted. Shelf is to be painted to match the cabinet color.
2900-1042	1	ADJUSTABLE SHELF, LOWER FRONT WALL CABINET Fab and install an adjustable aluminum shelf in the lower section of the front wall cabinet as noted. Shelf is to be painted to match the cabinet color.
2900-1012	1	ACRYLIC HINGED DOORS, Lower front wall Cabinet specified above is to have two 3/8" acrylic vertically hinged doors.
2900-1032	4	SOUTHCO SS PULL STYLE LATCH LOWER FRONT WALL DOOR Install stainless flush mount Southco pull latches on the selected hinged doors on the lower front wall cabinet.
2900-1021	6	SELF CLOSING HINGES LOWER FRONT WALL CABINET The lower front wall cabinet door(s) is/are to use self-closing style hinges.
2000-1402	1	CAB TO MODULE WALKTHROUGH DOOR, POCKETED Install a recessed hinged front cabin closeout door on the right front compartment wall.
VISUAL WARNING		
SR00029266	1	M9 REAR FACE LIGHTING NOTE: REAR FACE M9 LIGHTS ARE TO BE IN LINE WITH THE LOAD LIGHTS.

Option	QTY	Description
3000-0044	1	WIG WAG HEADLIGHTS, E SERIES Install wig wag headlight flasher. Provide a dedicated switch in the front control panel. Deactivate with high beams and in secondary mode.
3500-5012	2	M7 RED/CLEAR LENS - REAR WHEEL WELLS Install Whelen M7 series LED lights as noted. Lights to be red with clear lenses. Lights to include chrome flanges and flash pattern programmability from the front control panel.
SR00029270	1	Install four Whelen M9 Duo Red/Blue lights, M92J. Locate two on the rear face outboard of loading lights, in line with the loading lights Locate two on the front face upper center per drawings.
3000-5085	1	M9 White Clear Lens Front Center KKK Install a Whelen M9 series LED light centered on the front face of the body. Light is to be white with a clear lens. Light is to include a chrome flange and flash pattern programmability from the front control panel.
3000-5102	1	M6 Amber/Clear Lens Rear Center KKK Install a Whelen M6 series LED light centered on the rear face of the body above the rear doors. Light is to be amber with a clear lens. Light is to include a chrome flange and flash pattern programmability from the front control panel.
3000-5018	6	M9 RED/CLEAR LENS - FRONT FACE OUTER MOST & INNER MOST - REAR FACE CORNERS Install Whelen M9 series LED lights as noted. Lights to be red with clear lenses. Lights to include chrome flanges and flash pattern programmability from the front control panel.
3300-5018	4	M9 RED/CLEAR LENS - (2) STREET SIDE, (2) CURBSIDE - UPPER CORNERS Install Whelen M9 series LED lights as noted. Lights to be red with clear lenses. Lights to include chrome flanges and flash pattern programmability from the front control panel.
3000-0137	1	FLASH PATTERN, TRIPLE A, B, C, D Program the emergency lighting flash pattern to triple A/B/C/D.
3000-5109	1	Chevron Style Lighting Red/Amber Install 12" LED light strips with bezels on the rear of the body five (5) per side. Lights are to be installed at an angle to mimic a chevron pattern. To include (3) red and (2) amber on either side of the rear doors in an alternating pattern.
SR00029272	1	Install four grill lights, two upper and two lower. This lights are to be ION Whelen DUO Red/Blue. #I2SMJ
3000-3516	1	RED/CLEAR LENS M7 LED INT. LIGHTS Install Whelen M7 series LED lights as intersection lights on each side of the chassis. Lights to be red with clear lenses. Lights to include chrome flanges and flash pattern programmability from the front control panel.

Option	QTY	Description
AUDIBLE WARNING		
3000-0174	1	SIREN: WHELEN HFS295C9 Install a Whelen HFS295C9 siren in the front console.
3000-1542	1	SPEAKERS, CAST PRODUCTS, E SERIES Install Cast Products siren speakers, applicable to Ford E-Series chassis, in the front bumper.
NON-EMERGENCY LIGHTING		
SR00029261	1	CHROME BEZELS: All applicable lights (lights without chrome housings) are to have chrome bezels.
3000-0208	1	KKK SIDE BODY MARKER LIGHTS, M6 SERIES LED (PAIR) Install red Whelen M6 series LED turn/marker lights on each rear side of the module body. Lights provide module body night time side lighting visibility and turning signal indication. Lights do not flash with warning lights unless otherwise specified. Includes chrome flanges.
3000-0217	1	LED EXTERIOR COMPARTMENT LIGHTING Install full height LED strip lighting in all exterior compartments with the exception of any wheelwell compartments. Install vertical strips inside both sides of each compartment. The lights are to be directed toward the back of each compartment.
SR00029269	1	INSTALL NEW DESIGN ROLLED MARKER LIGHT TRAFFIC ADVISOR !!! INSTALL THE STANDARD OLD STYLE REAR LED "ICC" LIGHTS BELOW THE DRIP RAIL. !!! INSTALL (10) SINGLE STYLE AMBER ROLLED MARKER LIGHTS ON THE REAR ROOF EXTRUSION TO BE USED AS A REAR TRAFFIC ADVISOR !!! PROGRAM THESE LIGHTS THROUGH THE I4G IN A TRAFFIC ADVISOR PATTERN: CENTER OUT - RIGHT TO LEFT - LEFT TO RIGHT - RANDOM FLASH !!! INCLUDE I4G PROGRAM BUTTONS ON THE FRONT CONTROL PANEL FOR THESE FUNCTIONS These lights to work any time Module Disconnect is turned on.
3000-0224	1	RUNNING BOARD LIGHTS, WHELEN PAR 16 L.E.D. Install a pair of Whelen PAR 16 LED lamps with chrome flanges in the stainless steel stone guard above each running board, one per side. Wire to the chassis door switch and illuminate the step/running board.
3000-0690	1	L.E.D. WARNING RUB RAILS RED/WHITE Install 12" Tecniq L.E.D. light strips in the lower rub rails. The lights are to be dual color red/white. Locate (3) strips forward of the rear wheel and (2) strips aft of the rear wheel for a total of (5) lights. Steady burn the red light sections with headlight switch and alternate flash red and white light sections with warning lights activated.
SR00029277	1	Program Red Rub Rail warning to flash with corresponding turning circuit IATS standard programming.

Option	QTY	Description
3000-3834	1	LIGHTED DOOR HANDLES, BLUE Install blue LED lights in the module door handles. Lights to activate with marker lights 'on' and vehicle in 'Park'.
3000-0240	1	M9 SERIES LED SCENE LIGHT, STREETSIDE FRONT Install a Whelen M9 LED side scene light with chrome flange on the upper streetside forward portion of the body.
3000-0741	1	M9 SERIES LED SCENE LIGHT, STREETSIDE REAR Install a Whelen M9 LED side scene light with chrome flange on the upper streetside rear portion of the body.
3000-0748	1	M9 SERIES LED SCENE LIGHT, CURBSIDE FRONT Install a Whelen M9 LED side scene light with chrome flange on the upper curbside forward portion of the body.
3000-0762	1	M9 SERIES LED SCENE LIGHT, CURBSIDE REAR Install a Whelen M9 L.E.D. side scene light with chrome flange on the upper curbside rear portion of the body.
3000-1633	1	LOAD LIGHTS, M9 SERIES LED Install two Whelen M9 LED load lights with chrome flanges above the rear body entry doors.
3000-1756	1	AMBER WARNING, TOP, SIDE ACCESS DOOR Install a Tecniq amber L.E.D. light strip on the upper curbside access door inner panel. Installation will be near flush with the inner door panel. The light strip is to flash when the access door is open, and the emergency lighting is activated.
3000-1761	1	AMBER WARNING, TOP, REAR ACCESS DOORS. Install Tecniq amber L.E.D. light strips on the upper rear module access door inner panels, one (1) per door. Installation will be near flush with the inner door panels. The light strips are to flash when the access doors are open, and the emergency lighting is activated.
3000-0648	1	AMBER WARNING LIGHT, TOP, STREETSIDE FRONT Install a Tecniq Amber L.E.D. light strip on the upper streetside forward compartment door inner panel. Installation will be near flush with the inner door panel. The light strip is to flash when the compartment door is open, and the emergency lighting is activated.
3000-0649	1	AMBER WARNING LIGHT, TOP, STREETSIDE INTERMEDIATE Install a Tecniq Amber L.E.D. light strip on the upper streetside intermediate compartment door inner panel. Installation will be near flush with the inner door panel. The light strip is to flash when the compartment door is open, and the emergency lighting is activated.

Option	QTY	Description
3000-0650	1	AMBER WARNING LIGHT, TOP, STREETSIDE REAR Install a Tecniq Amber L.E.D. light strip on the upper streetside rear compartment door inner panel. Installation will be near flush with the inner door panel. The light strip is to flash when the compartment door is open, and the emergency lighting is activated.
SR00029263	1	AMBER WARNING LIGHT LOCATION: The street side intermediate and rear amber warning lights will be on the rear facing doors only.
3000-0645	1	AMBER WARNING LIGHT, TOP, CURBSIDE FRONT Install a Tecniq Amber L.E.D. light strip on the upper curbside forward compartment door inner panel. Installation will be near flush with the inner door panel. The light strip is to flash when the compartment door is open, and the emergency lighting is activated.
3000-0647	1	AMBER WARNING LIGHT, TOP, CURBSIDE REAR Install a Tecniq Amber L.E.D. light strip on the upper curbside rear compartment door inner panel. Installation will be near flush with the inner door panel. The light strip is to flash when the compartment door is open, and the emergency lighting is activated.
3000-1438	1	TAIL LIGHTS, M6 SERIES, HORIZONTAL MOUNTED Install Whelen M6 series LED stop/tail, turn, and reverse lights. Install the stop/tail and reverse lights in the rear riser/kick plate with brake/tail outboard. Install the turn signals above in the rear body panels. Lights to include chrome flanges.
3000-0267	1	ARROW LIGHTS M6 SERIES LED, FRONT Install (2) Whelen M6 series LED turn signals on the front face of the body below the outboard flashers and wire into the turn signal circuit. Lights to include chrome flanges.
ELECTRICAL		
3000-0018	1	ELECTRIC DOOR LOCKS COMPARTMENT EXTERIOR Install power activated door locks on all exterior compartment doors. Locks to be activated by a switch at each patient area access door. Locks may be overridden by a door key.
3000-0019	1	ELECTRIC DOOR LOCKS ACCESS DOORS INTERIOR Install power activated door locks on all patient area access doors. Locks to be activated by a switch at each patient area door. Locks may be overridden by a manual slide lever or by the door key.
3000-0022	1	ELECTRIC DOOR LOCKS WIRED TO OEM SWITCHES The specified power door locks are to be wired to the chassis OEM door lock switches.
3000-0020	1	ELECTRIC DOOR LOCKS CONCEALED IN GRILLE Install a concealed switch in the chassis grille to operate the power door lock circuit. Doors shall be wired to unlock only on this circuit.
3000-0026	1	REAR RADIO SPEAKERS OVER REAR DOORS Install two (2) rear AM/FM radio speakers in the patient compartment over the rear doors. Provide volume control in the rear switch panel.

Option	QTY	Description
3000-2222	1	360 DEGREE MARKER LIGHTS, EMERGENCY FLASH Install rolled marker lights on the upper corners of the body front and rear to provide 360 degree lighting coverage. Program the 360 degree marker lights to flash in addition to normal operation.
3000-0282	1	ELECTRICAL SYSTEM Install the Intelliplex i4G electrical system. System is to include a USB port installed under the dash for ease of programming.
3000-0305	1	INPOWER BATTERY SWITCH, WITH WAKE BUTTON - 5 min. Install an Inpower electronic battery switch. Switch is to activate battery power through the vehicle ignition and is to include an automatic shutdown timer to deactivate battery power after the ignition is turned off. To include a wake button installed on the front console to activate the electrical system without using the key.
3000-0303	1	PREWIRE, 1000TUL INTERFACE Furnish wiring only to the designated electrical equipment location to power a Vanner 20-1000TUL inverter. This includes prewire and programming for a control switch in the rear control panel. Inverter is not included in this option.
3000-0307	1	CHARGER/POWER SUPPLY, 45 AMP Install a 45 amp battery conditioner in the designated electrical equipment area. Conditioner to be wired to the batteries through the shoreline inlet.
3000-0310	3	110V INTERIOR OUTLET - (1) INHALATION AREA (1) TELEMTRY AREA WALL (1) UPPER FRONT WALL CABINET Install a 110V outlet(s) as noted.
3000-0549	3	INTERIOR 12VDC OUTLETS: CL TYPE/USB - (1) INHALATION AREA (1) TELEMTRY AREA WALL (1) UPPER FRONT WALL CABINET - !!! BATTERY HOT Install a 12VDC cigarette style/USB outlet(s) as noted.
SR00029276	1	Horton to supply and install a kussmaul usb port # 091-219-4 on front console face plate.
3000-1463	1	SHORELINE 1, 20A SUPER AUTO EJECT, WHITE Mount a Kussmaul Super Auto Eject 20 amp shoreline inlet in the standard location. Cover is to be white.
3000-1500	1	PD BOX LOCATION, LEFT HAND SIDE, SS INT. COMPARTMENT Install the power distribution panel on the left hand side of the streetside intermediate compartment. Close off this area from the remainder of the compartment.
3000-0332	1	REPORT LIGHT, LED Install a 12" LED report light on the action wall to light the counter area.
3000-0340	1	CLOCK, DIGITAL W/SECONDS: OVER REAR DOORS Install a Horton large face digital 12/24 hour clock with seconds display over the rear doors.
3000-0344	2	STEP WELL LIGHT VISTA LED

Option	QTY	Description
		Install a 10.5" LED Vista light strip in the standard location on the bench side of the step well. Light to activate with door open.
3000-0346	1	2.5" CAB CEILING LIGHTS, WHITE/RED LED Install (2) combination white/red LED dome lights in the cab headliner. Locate one light over the driver and one light over the passenger. Wire to a switch in the front control panel and provide 'OFF', 'CLEAR' and 'RED' selections.
3000-0350	1	ROM DUROLUMEN LED ABOVE HEAD IN CEILING Install ROM Durolumen LED ceiling light fixture. Wire to charger/conditioner (if applicable) in addition to standard mode of operation.
3000-0583	1	ROM DUROLUMEN LED ABOVE WAIST IN CEILING Install ROM Durolumen LED ceiling light fixture. Wire to charger/conditioner (if applicable) in addition to standard mode of operation.
3000-0584	1	ROM DUROLUMEN LED ABOVE FOOT IN CEILING Install ROM Durolumen LED ceiling light fixture. Wire to charger/conditioner (if applicable) in addition to standard mode of operation.
3000-0359	8	PATIENT CEILING DOME LIGHTS WHELEN LED Install Whelen 80COEHCR LED dome lights in the patient area ceiling. The lights will have a high/low feature with the switch in the rear control panel.
3000-0522	1	3 SWITCH PANEL BOLSTER FACE STEP WELL Install an i4G 3-switch control panel on the bench bolster facing the stepwell.
3000-2100	1	TIMER, DOME LIGHTS. STEPWELL Install an electronic momentary touch timer switch in the specified I4g switch panel on the side of the bolster facing the side stepwell. The switch will enable time limited operation of the specified dome lights with the battery switch in the 'off' position. Set timer to 15 minutes.
3000-2110	1	TIMER, FLUOR/LED BOLSTER STEPWELL Install an electronic momentary touch timer switch in the specified I4g switch panel on the side of the bolster facing the side stepwell. The switch will enable time limited operation of the specified fluorescent/LED check-out lights with the battery switch in the 'off' position. Set timer to 15 minutes.
3000-0380	1	SECURITY IDLE SYSTEM, E SERIES Install a security idle system. Delete horn activation feature.
3000-0007	1	BACKUP ALARM RESET, MOMENTARY Install a back-up alarm and provide a momentary backup alarm reset button on the front console.
3000-1905	1	360 CAMERA SYSTEM, WHITE Install a Horton 360 Degree camera system with white covers and integral lighting. The lighting is to have the ability to function in emergency response mode. The display will

Option	QTY	Description
		function in conjunction with the turn signals and when the vehicle is in reverse gear. Install rear housing if space is available. If space is unavailable then install camera only.
SR00029268	1	RVS-619-NM MONITOR, WINDSHEILD Remove the Ford OEM Mirror and replace it with a RVS-619-NM monitor. Wire the 360 Camera System to this monitor. Ship the OEM Mirror loose.
PROGRAMMING		
SR00029260	1	Horton to program front control panel illumination ring to patient status indicators.
6000-0001	1	LIGHT PROGRAMMING: SIDE REAR SCENE The side rear scene lights shall be wired to transmission reverse, plus standard mode of operation.
6000-0002	1	LIGHT PROGRAMMING: RIGHT SIDE SCENE The right side scene lights shall come "on" when the side patient door is opened.
6000-0003	1	LIGHT PROGRAMMING: LOAD LIGHT Program the rear load lights to activate with transmission reverse plus the standard mode of operation.
6000-0006	1	PROGRAMMING: AUDIBLE LOW VOLTAGE ALARM Program an audible alarm to activate if the voltage drops below 11.8 volts for 120 seconds.
6000-0010	1	LIGHT PROG: BRAKE LIGHT, BRAKE OVERRIDE Program the lower red flashing warning lights to operate as supplemental brake lights. The brake light feature is to override the warning mode. Once the brake is released then the lights should return to flashing.
6000-0011	1	BRAKE ACTIVATED CHEVRON LIGHTING The specified red chevron style lighting on the rear of the vehicle is to switch to steady burn with the brake light circuit. The warning light function is to override this feature.
6000-0012	1	TURN SIGNAL ACTIVATED CHEVRON LIGHTING The amber conspicuity/chevron lighting is to wired to operate as auxiliary turn signals when not in warning mode.
6000-0009	1	LIGHT PROGRAMMING: CAB LIGHT CONTROL The selected rear patient area dome lights are to be controlled through switching provided on the front control panel in addition to standard.
6000-0017	1	SIDE MARKER LIGHT PROGRAMMING The selected side body marker lights are to be programmed to flash with the emergency lighting. Turn signal function is to override this programming.
SR00029280	1	Horton to program triple flash pattern for rub rail lights to alternate R/W. Horton to program compartment warning lights to triple flash and alternate lights within lighthouse if possible.

Option	QTY	Description
SR00029281	1	Add I4G code lights for patient status
HVAC		
3000-1606	1	COOLTECH I, E SERIES Install a Cool-Tech I 4-fan 100,000 BTU condenser in the recessed pocket in the roof of the body.
3000-4027	1	12V HVAC, ATTENDANT'S SEAT Install a ProAir Pre-charged 12V heat/AC system with brushless motor below the attendant seat.
3000-0423	1	ULTRAVIOLET LAMP IN A/C SYSTEM DUCT Install an ultraviolet light in the A/C air duct.
2000-0435	1	VENT CAST PAINTED NFPA STYLE Install an NFPA style venting system to include a 400cfm exhaust vent along with a static vent. Install 9.5" square cast covers on both vents per drawings. Covers to be painted body color.
RADIO		
3000-0432	1	ANTENNA COAX 1 - Start: Cab Console, End: Front Center of Mod Roof An RG 58U coax shall be installed terminating as noted above.
3000-0608	1	ANTENNA COAX 2 - Start: Cab Console, End: Center of Mod Roof An RG 58U coax shall be installed terminating as noted above.
3000-0609	1	ANTENNA COAX 3 - Start: Inhalation Wall, End: Rear Center of Mod Roof An RG 58U coax shall be installed terminating as noted above.
3000-0434	1	3/8" NMO MOUNT COAX 1 Supply and install a 3/8" NMO mount in conjunction with specified coax #1.
3000-0618	1	3/8" NMO MOUNT COAX 2 Supply and install a 3/8" NMO mount in conjunction with specified coax #2.
3000-0619	1	3/8" NMO MOUNT COAX 3 Supply and install a 3/8" NMO mount in conjunction with specified coax #3.
1000-0416	1	CONSOLE, CUSTOM E SERIES NON-VINYL Fabricate and install an aluminum cab console and spray with black Scorpion material. Console is to include three (3) map/book slots at the rear of the console.
SR00029259	1	VCI STYLE CONSOLE: The cab console shall be constructed from aluminum and covered with black scorpion coating. The console shall provide installation space for radio heads in addition to the standard electrical control panel and siren. The rear section of the console will have three front to rear storage sections for maps, books etc.
1000-0179	1	CUP HOLDERS, 2-TIER

Option	QTY	Description
		Install two (2) two-tier style cup holders recessed into the console.
3000-5156	1	POWER TERMINAL, DUAL, BEHIND DRIVER Install three (3) 10 gauge 30 amp cables to positive and ground studs behind the driver's seat for radio power. Wire one constant hot, one ignition hot and a ground.
3000-5157	1	POWER TERMINAL, DUAL, INSIDE CONSOLE Install three (3) 10 gauge 30 amp cables to positive and ground studs for radio power. Wire one constant hot, one battery switched, and the third as a ground.
3000-5160	1	POWER TERMINAL, DUAL, INHALATION PANEL Install three (3) 10 gauge 30 amp cables to positive and ground studs for radio power. Wire one constant hot, one battery switched, and the third as a ground.
OXYGEN		
4000-0001	1	O2 MOUNT, VERT TRACK FOR QRM-V Vertical track for mounting of a QRM-V O2 bottle mount shall be welded on the back wall of the streetside forward compartment in the right hand corner. Bracket will be set up for an 'M' sized bottle.
4000-0018	1	O2 BOTTLE, BRACKET QRM-V Install a Zico QRM-V oxygen bracket for 'M' bottle. Locate in the streetside forward compartment.
4000-0019	1	OXYGEN ACCESS Provide access to the oxygen cylinder valve through the wall as depicted on the drawings. The door shall be hinged so that it swings into the oxygen cylinder storage compartment. Door material is to match other selected cabinet doors. The opening shall be 7" wide x 11" high and trimmed with anodized aluminum.
4000-0022	2	O2 OUTLET, OHIO MEDICAL - 2 In Inhalation Panel Install O2 outlets per instructions above. Outlets to be Ohio Medical style.
4000-0025	1	OXYGEN WRENCH Install oxygen wrench in oxygen compartment. Mount securely to wall. Mount with length of chain or cable to allow for use without being removed from the compartment.
4000-0103	1	D MOUNT: QR-D-2, STRAPLESS UNDER BENCH HEAD LOC 2 Install a Zico QR-D-2 Quic-release strapless d-cylinder oxygen bracket.
4000-0179	1	ASPIRATOR, SSCOR, INHALATION AREA Install an SSCOR aspirator. The system shall include a wall mounted regulator and a canister holder. Plumb to the selected pump.
4000-0089	1	VACUUM PUMP CAPL #D34 SE (P282) Install a CAPL #D34 SE (P282) 12vdc electric suction pump.

Option	QTY	Description
4000-0076	1	D MT: QR-D-2, STRAPLESS Under Bench Head LOC 1 Install a Zico QR-D-2 Quic-release strapless d-cylinder oxygen bracket.
CERTIFICATIONS		
7000-0001	1	KKK-A-1822F CERTIFICATION LABEL The vehicle shall have weight/payload, electrical load and KKK-A-1822F certification stickers installed in the O2 compartment.
CO00033151	1	Change Order- drawing update Drawing updated to show correct height of clear door opening based on CN10 latch bar. Upper and lower doors will not be identical heights. (BCD 11/16)

COMP	INSIDE WIDTH	INSIDE HEIGHT	INSIDE DEPTH	CLEAR OPENING WIDTH	CLEAR OPENING HEIGHT
CS REAR	26.29	80.13	20.36	22.13	79.16
CS INT	19.57	29.05	20.36	16.70	25.18
CS ROW	73.16	8.25	20.36	44.51	6.36
CS FWD	29.00	65.00	30.25	22.13	82.16

553B EXTERIOR
E-SERIES CHASSIS

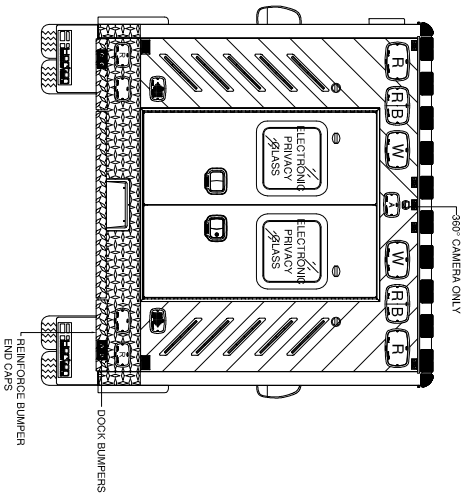
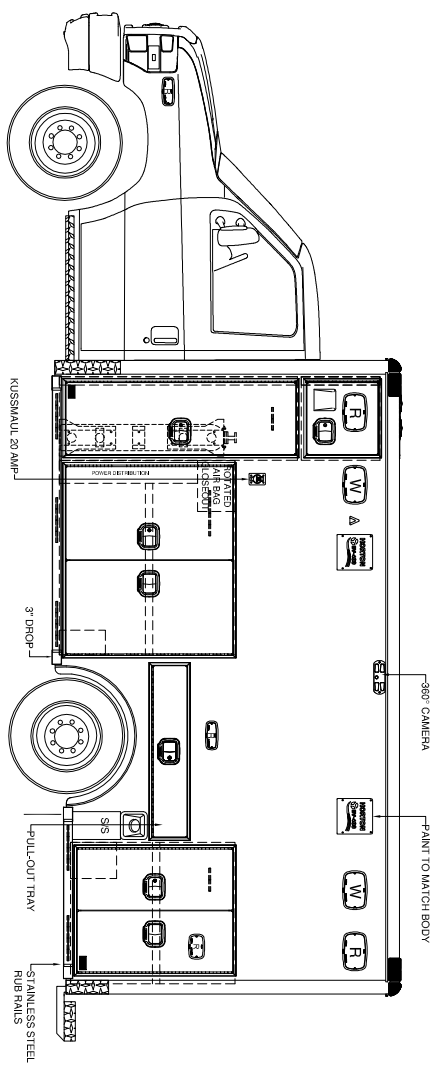
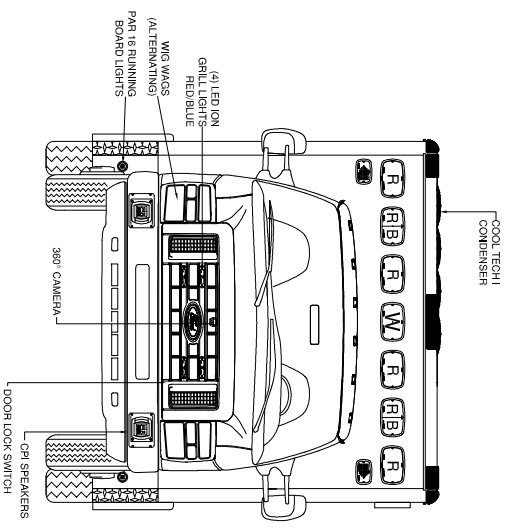
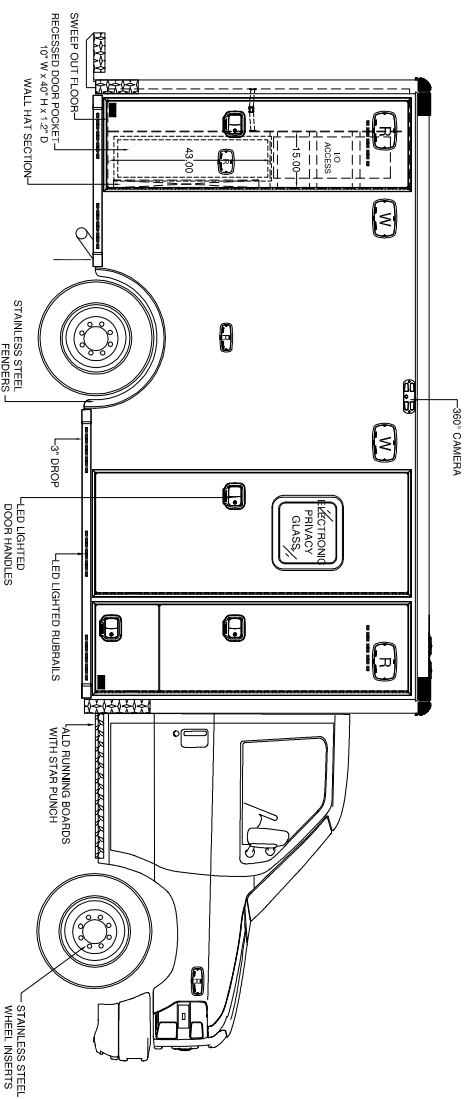

COMP	INSIDE WIDTH	INSIDE HEIGHT	INSIDE DEPTH	CLEAR OPENING WIDTH	CLEAR OPENING HEIGHT
SS FWD	22.05	83.13	20.36	18.25	80.16
SS INT	51.57	48.50	20.36	49.28	43.37
SS LOW	49.77	8.25	20.36	44.51	6.36
SS REAR	37.44	43.50	20.36	32.09	40.37

NOTE: DRAWINGS ARE FOR GRAPHICAL REPRESENTATION ONLY. DIMENSIONS ARE APPROXIMATE & MAY VARY DURING CONSTRUCTION.

SPECIFICATION DRAWING

553B EXTERIOR
E-SERIES CHASSIS

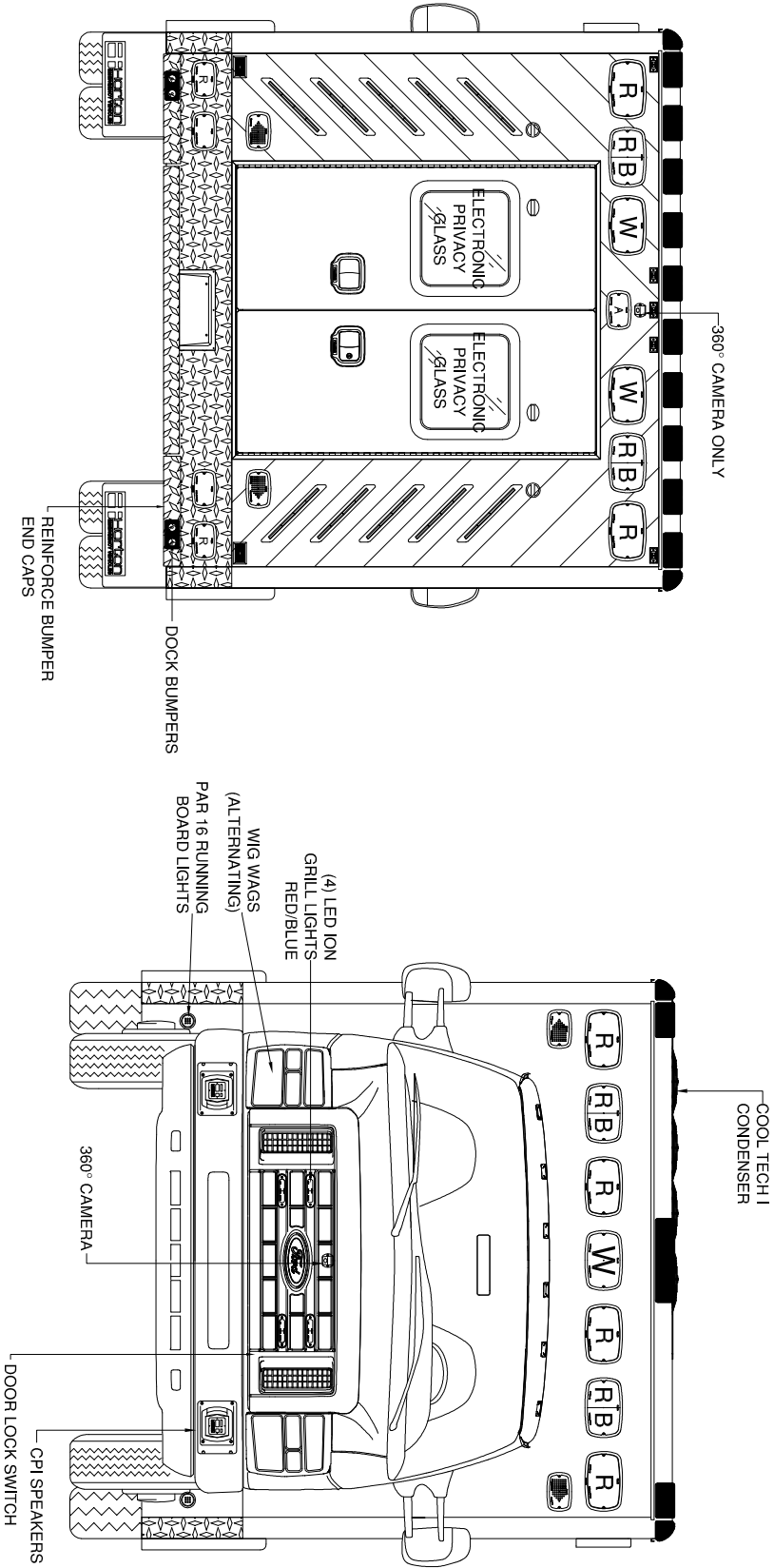

NOTE: DRAWINGS ARE FOR GRAPHICAL
REPRESENTATION ONLY
DIMENSIONS ARE APPROXIMATE & MAY VARY
DURING CONSTRUCTION

SPECIFICATION DRAWING

553B EXTERIOR
E-SERIES CHASSIS

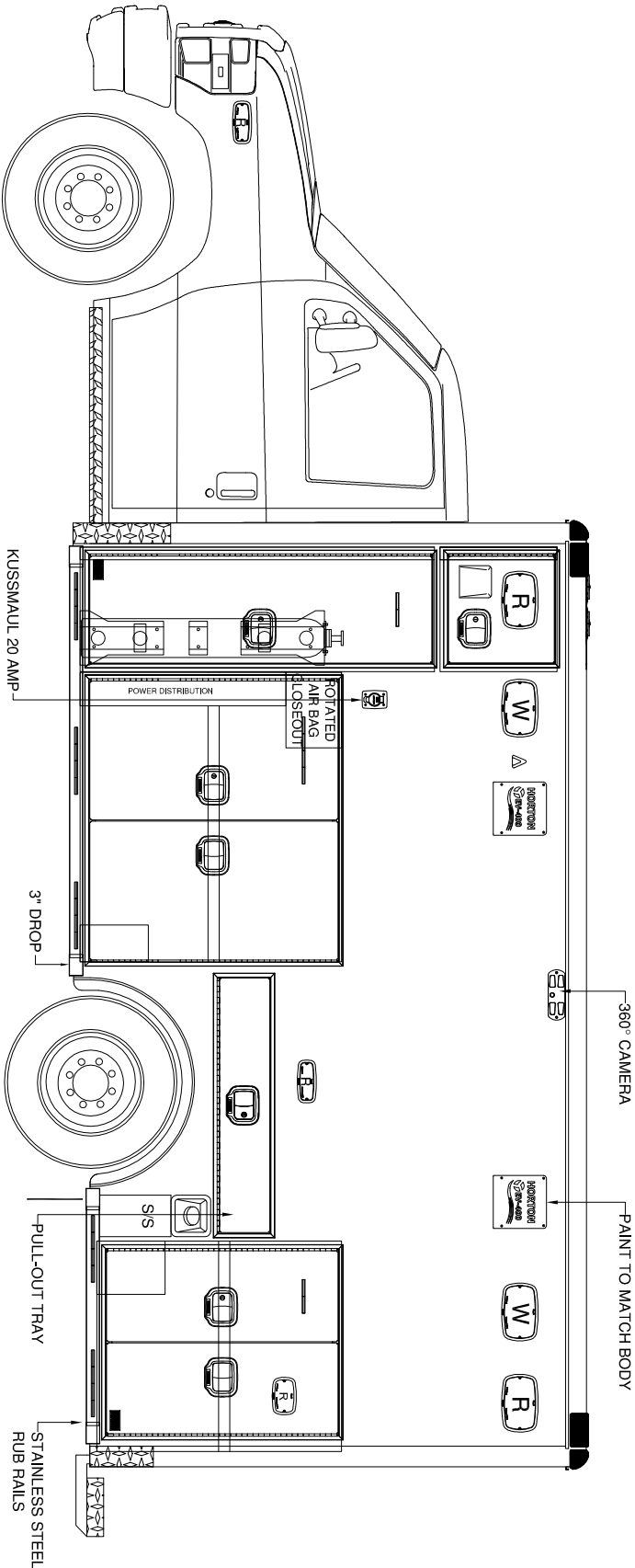

COMP.	INSIDE WIDTH	INSIDE HEIGHT	INSIDE DEPTH	CLEAR OPENING WIDTH	CLEAR OPENING HEIGHT
SS FWD	22.05	63.13	20.36	18.25	60.16
SS INT	51.57	46.50	20.36	49.28	43.37
SS LOW	49.77	8.25	20.36	44.51	6.36
SS REAR	37.44	43.50	20.36	32.09	40.37

NOTE: DRAWINGS ARE FOR GRAPHICAL REPRESENTATION ONLY. DIMENSIONS ARE APPROXIMATE & MAY VARY DURING CONSTRUCTION.

SPECIFICATION DRAWING

553B EXTERIOR
E-SERIES CHASSIS

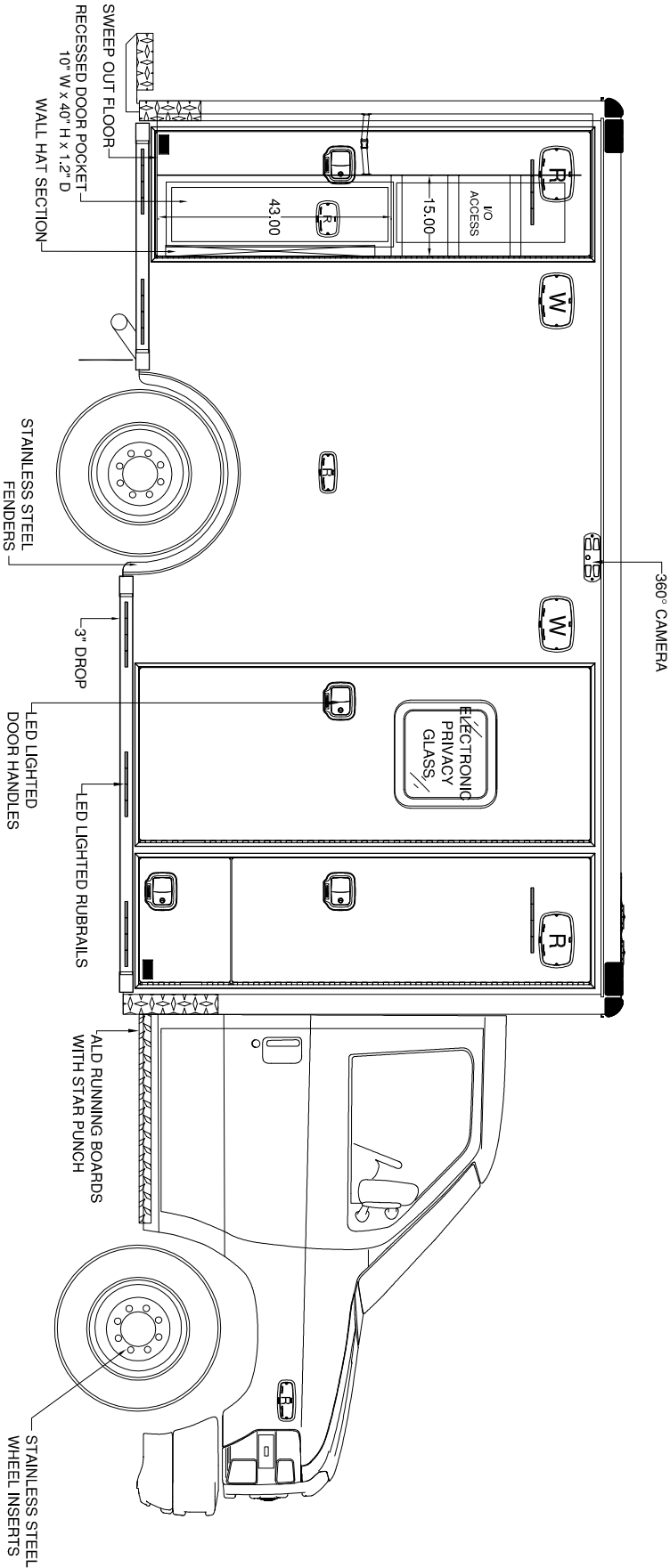

COMPT	INSIDE WIDTH	INSIDE HEIGHT	INSIDE DEPTH	CLEAR OPENING WIDTH	CLEAR OPENING HEIGHT
CS REAR	26.29	80.13	20.36	22.13	79.16
CS INT	19.57	28.05	20.36	16.70	25.18
CS ROW	73.16	8.25	20.36	44.51	6.36
CS FWD	29.00	65.00	30.25	22.13	82.16

NOTE: DRAWINGS ARE FOR GRAPHICAL REPRESENTATION ONLY
DIMENSIONS ARE APPROXIMATE & MAY VARY DURING CONSTRUCTION

SPECIFICATION DRAWING

553B CABINET WALL B
E-SERIES CHASSIS

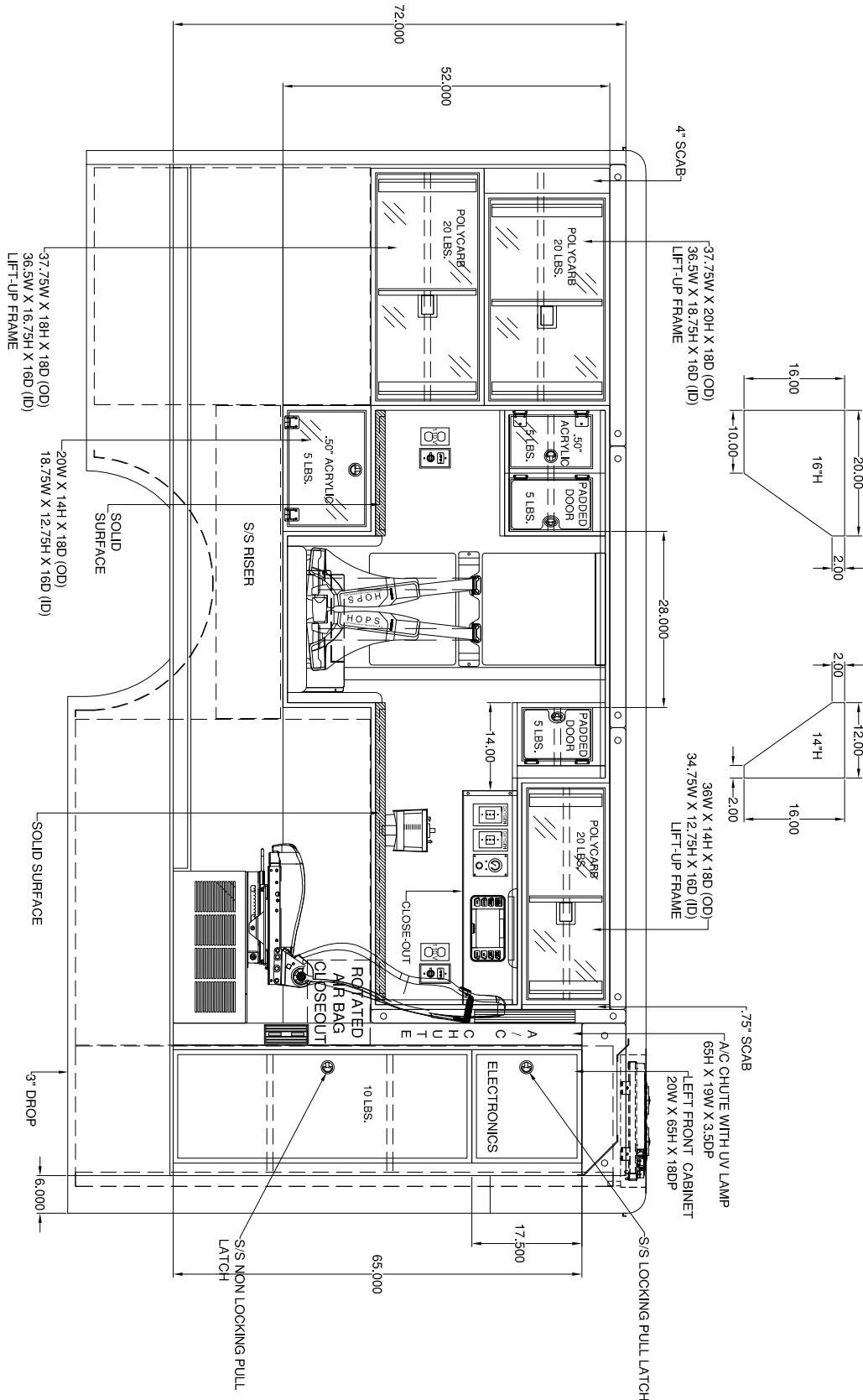

NOTE: DRAWINGS ARE FOR GRAPHICAL REPRESENTATION ONLY. DIMENSIONS ARE APPROXIMATE & MAY VARY DURING CONSTRUCTION

SPECIFICATION DRAWING

18921

REVISIONS		
REV	DESCRIPTION	DATE
	563B SIDE WALL	10/25/11
DRAWN BY: CMH		

HOPS

6,000
3" DROP
VISTA LED STEPWELL LIGHT
S/S LOWER DOOR PANEL
DOOR LOCK SWITCH
VISTA LED STEPWELL LIGHT
PULL OUT DRAWER SHARPS WASTE 11.5"W x 10.625"H x 16.25"D (I.D.)
S/S RISER
SHARPS 8970 & GDL.

AMBER LED- 3-PIECE DOOR PANEL
ELECTRONIC PRIVACY GLASS
1.5" RADIUS TRIM
34W X 9H X 8D
5 LBS. .50" ACRYLIC
41W X 9H X 8D
1 INCH SCAB

24,000
24,000
13,000
19,000
72,000

**NOTE: DRAWINGS ARE FOR GRAPHICAL REPRESENTATION ONLY
DIMENSIONS ARE APPROXIMATE & MAY VARY DURING CONSTRUCTION**

SPECIFICATION DRAWING

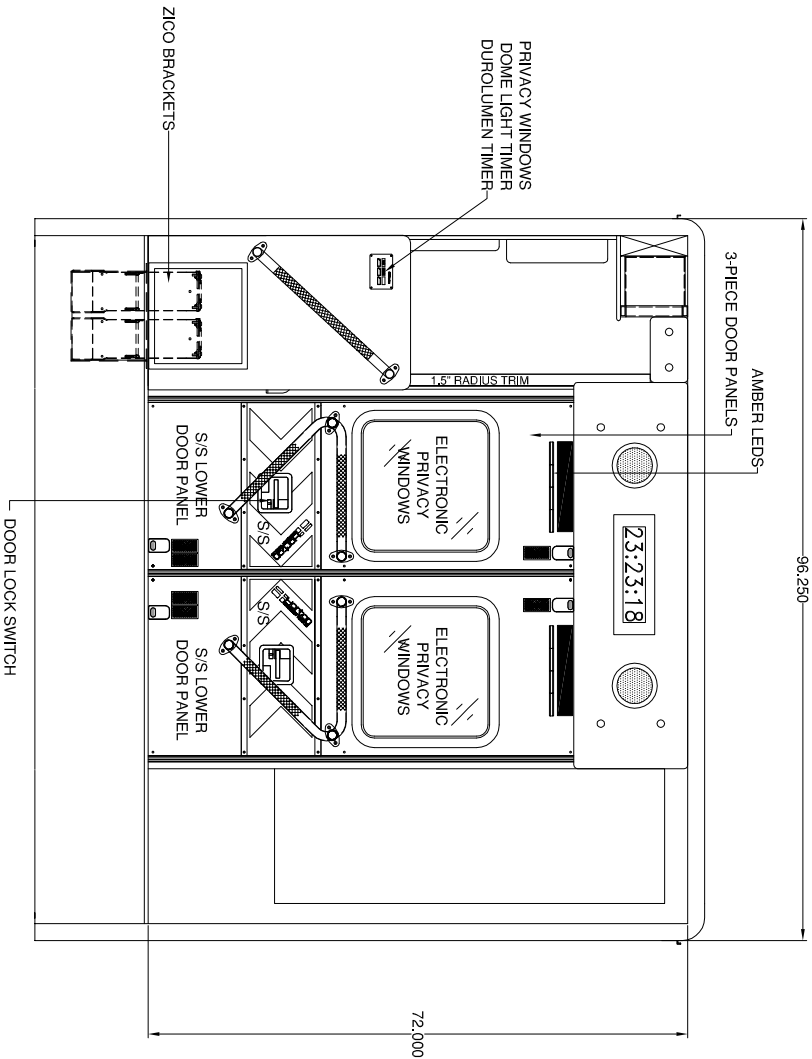

NOTE: DRAWINGS ARE FOR GRAPHICAL REPRESENTATION ONLY
DIMENSIONS ARE APPROXIMATE & MAY VARY DURING CONSTRUCTION

SPECIFICATION DRAWING

553B OVERHEAD "B" WITH CPR SEAT
E-SERIES CHASSIS

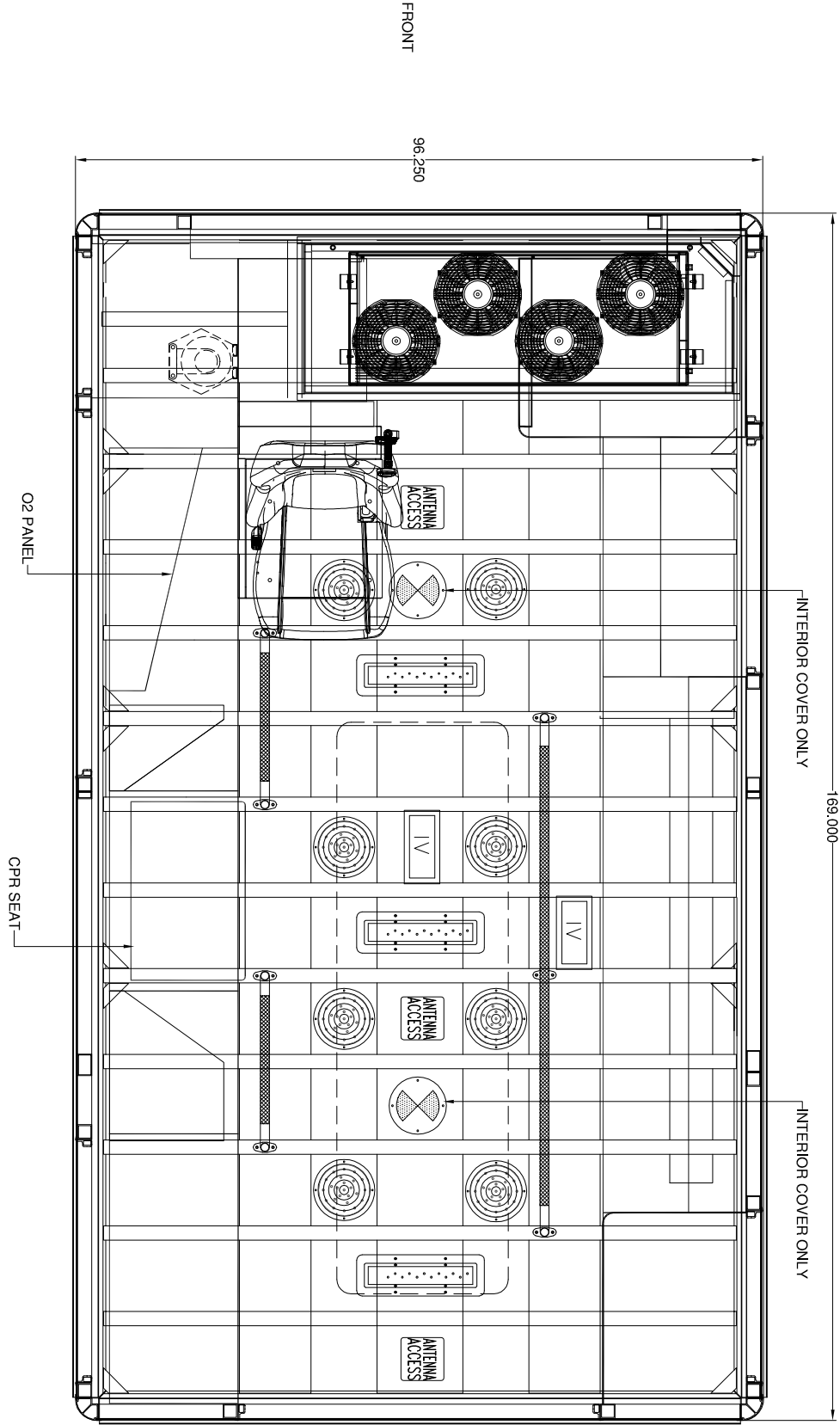

NOTE: DRAWINGS ARE FOR GRAPHICAL REPRESENTATION ONLY. DIMENSIONS ARE APPROXIMATE & MAY VARY DURING CONSTRUCTION

SPECIFICATION DRAWING

18921

REVISIONS		
REV	DESCRIPTION	DATE
	CONSOLE DRAWING	10/25/18

DRAWN BY: CMH

IN POWER BUTTON

360 CAMERA SWITCH

20.43

HFS295C9 SIREN

DUAL USB

ADJUSTABLE DIVIDERS

12.50

16.25

TOP VIEW

12.25

11.00

4.25

25.22

33.54

6.25

15.00

1.50

DASH

14.00

21.00

SPECIFICATION DRAWING